



TRACTEBEL



ENGIE

SUSTAINABILITY @ WORK

Urban Development

Makes sustainability tangible and profitable during the entire life of a project

Tractebel is a worldwide multidisciplinary engineering, consultancy and design firm working on a wide range of projects in geographies around the world. Every day our teams of engineers, consultants and designers feel the need for a more sustainable urban development to build a better world for all, today and in the future. Therefore we developed together 11 integrated approaches for cities and territories; they represent the needs and interests of cities and citizens and aim to provide solutions to key global challenges.

why?

Sustainability is often perceived as an abstract, somewhat theoretical concept. Nevertheless, sustainability is becoming a key issue in all development plans and projects. **The future focus will be on making sustainability tangible and profitable in all project's phases.** Integrating sustainability will engender better environmental results and create a broader support and more security (financial, procedural and legal).

what?

Sustainability @ work concentrates on sustainability as the main aspect in the process of development of human settlements, from neighbourhoods to cities and territories. Sustainability is considered as an ultimate ambition within urban developments: **a needed shift from existing schemes (production-consumption-disposal) to new models that enable communities to live in harmony with the environment.**

Sustainability @ work takes into consideration the economic, social and environmental advantages of applying circular principles and processes during the entire life of a project. Sustainability @ work develops **strategies and actions to regenerate and restore natural capitals, maximise resource usage, reduce consumptions, optimise performances, recycle materials and products, virtualise services** and more. Integrating sustainability in plans and projects is not a cost, it's an investment.

Sustainability @ work applies to all the aspects of development projects, from (policy) planning to realisation, focusing on quality and sustainability throughout the full process.



Tuinen Van Stene, Ostend

Transforming a neglected historical landscape into a productive park for the city in which local food production, water retention, ecological optimization and recreational facilities are combined.

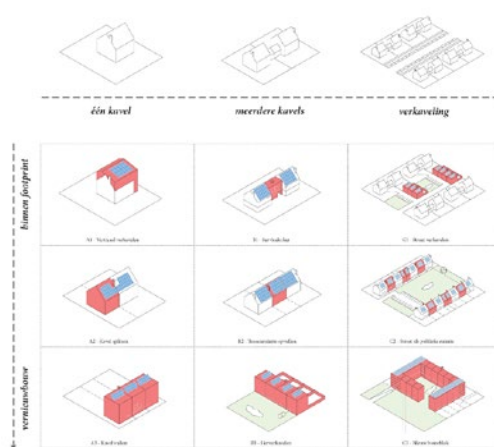

Efficient use of space for climate change adaptation, Belgium

This study develops a methodology for analysis and localisation of areas that can be re-used or transformed from their current destination to new urban projects or new green-fields.



Air quality mapping, Belgium

The goal of this study is to improve the quality of the living environment by integrating spatial solutions against environmental noise and air pollution into spatial policy.



FALCO project, Belgium

The 'Financing Ambitious Local Climate Objectives' are aimed at the heart of the funding question of local climate action plans. They focus on bridging the gap between plan and reality by bringing about financial solutions that will fuel ambitious local climate action plans.

10 other integrated approaches to discover

- Urban Resilience
- Productive Landscapes
- Places of Mobility
- Water Urbanism
- Eco-Districts
- Recycling Territories
- Smart Networks
- Civic Architecture
- Territorial Transitions
- Digital Urban Solutions